

MATCHLINE: SEE NEXT SHEET

WALMART FUEL STATION - STORE #1961
6711 EAST ALEXANDRIA PIKE, ALEXANDRIA, KY 41001
DESIGN CIVIL SITE PLAN

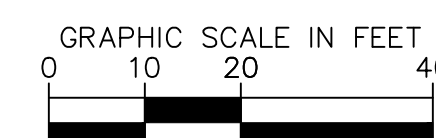
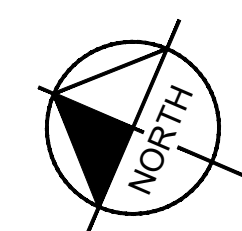

SCALE: 1" = 20'
WHEN PRINTED AT FULL
SIZE 24"X36"

LEGEND

---	PROPERTY LINE
- - -	EXISTING EASEMENT LINE
[Pattern: Heavy Dots]	HEAVY DUTY ASPHALT PAVING
[Pattern: Diagonal Lines]	LANDSCAPING
[Pattern: Grid]	CONCRETE SIDEWALK
[Pattern: Stippled]	CONCRETE PAVEMENT
[Pattern: Circles]	TRUNCATED DOMES

CONSTRUCTION NOTES

- 1 PROPOSED CONCRETE CURB AND GUTTER.
- 2 PROPOSED HEAVY DUTY ASPHALT PAVEMENT.
- 3 PROPOSED CONCRETE PAVEMENT.
- 4 STRIPE DIRECTIONAL ARROW PAVEMENT MARKING.
- 5 PROPOSED 4" YELLOW STRIPING ANGLED 45°.
- 6 STRIPE STOP BAR PAVEMENT MARKING.
- 7 PROPOSED STOP SIGN ON POST.
- 8 PROPOSED LANDSCAPING (SEE LANDSCAPE PLAN).
- 9 PROPOSED 1,618 SF CONVENIENCE STORE.
- 10 PROPOSED UNDERGROUND GAS TANKS. ONE 20,000 GAL UNL, ONE 20,000 GAL SPLIT (12,000 UNL/8,000 PRM), AND ONE 20,000 GAL DSL.
- 11 PROPOSED AIR STATION.
- 12 PROPOSED VAPOR RECOVERY LOCATION/PAD.
- 13 PROPOSED CANOPY.
- 14 PROPOSED TRUNCATED DOMES.
- 15 PROPOSED VAN ACCESSIBLE PARKING SIGN ON POST AND BOLLARD.
- 16 PROPOSED VAN ACCESSIBLE PARKING.
- 17 PROPOSED BOLLARD.
- 18 PROPOSED CONCRETE SIDEWALK.
- 19 PROPOSED TRASH ENCLOSURE.
- 20 PROPOSED REGULAR PARKING.
- 21 PROPOSED TRANSFORMER PAD SHOWN FOR REFERENCE ONLY.
- 22 PROPOSED SITE LIGHTING (SEE PHOTOMETRIC PLAN).
- 23 PROPOSED VALLEY GUTTER.
- 24 PROPOSED BIKE RACK.

SITE ANALYSIS TABLE

FUEL STATION ADDRESS	6711 EAST ALEXANDRIA PIKE, ALEXANDRIA, KY 41001	
CURRENT ZONING	NSC	
EXISTING PARCEL AREA	28.28 ACRES	
EXISTING WALMART BUILDING AREA	211,091 S.F.	
PROPOSED FUEL AREA	1.24 ACRES	
PROPOSED FUEL BUILDING AREA	1,440 S.F.	
	PARKING COUNT	PARKING RATIO
EXISTING TOTAL PARKING	941 SPACES	4.46/1,000 S.F.
EXISTING STANDARD STALLS	911 SPACES	---
EXISTING ADA STALLS	30 SPACES	---
PROPOSED TOTAL PARKING	775 SPACES	3.67/1,000 S.F.
CITY REQ. PARKING	950 SPACES	4.50/1,000 S.F.
WALMART REQ. PARKING	845 SPACES	4.00/1,000 S.F.
PROPOSED FUEL AREA PARKING		
PROPOSED STANDARD STALLS	15 SPACES	---
PROPOSED ADA STALLS	1 SPACES	---
TOTAL PROPOSED STALLS	16 SPACES	---

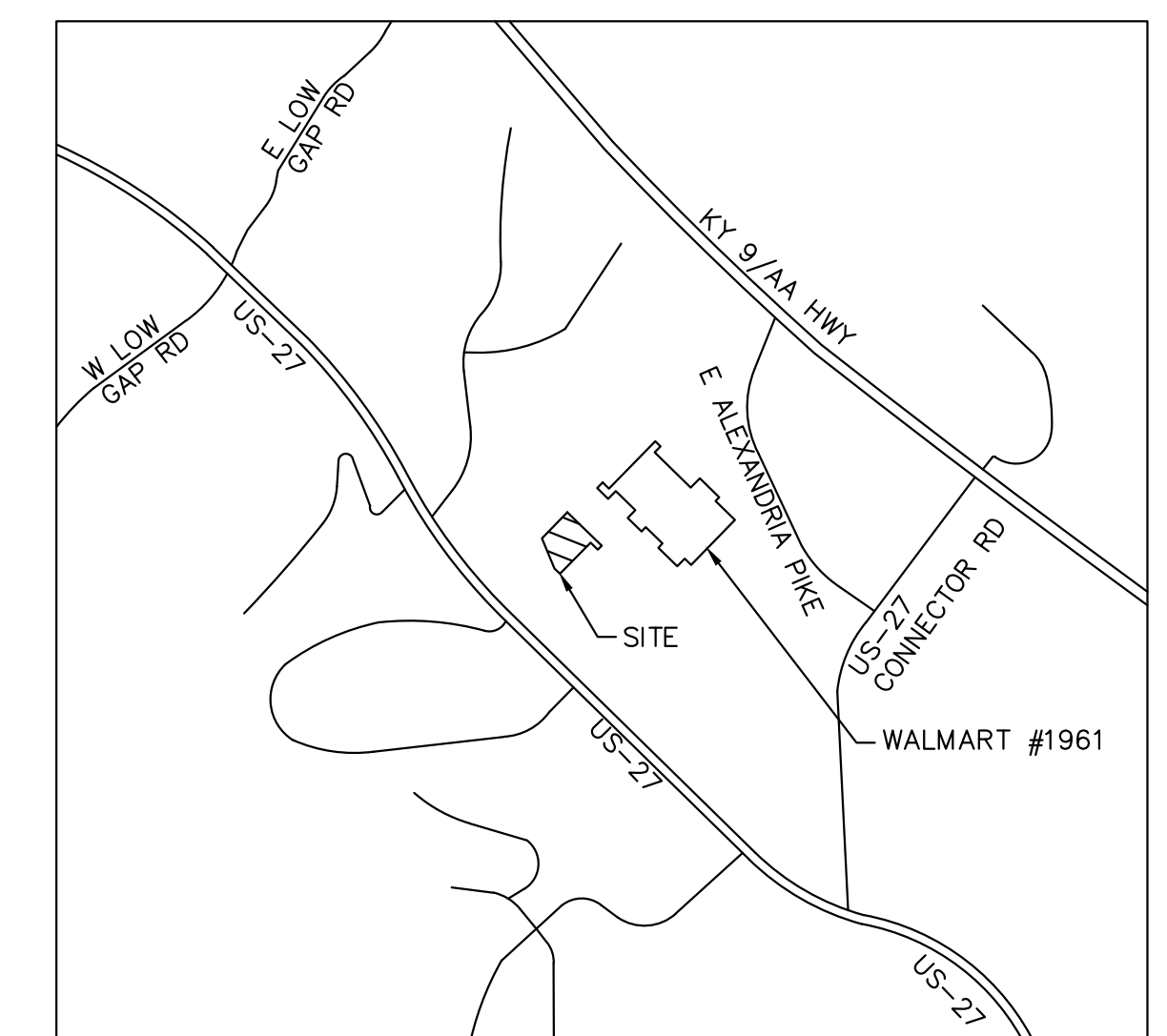

VICINITY MAP
N.T.S.

Kimley»Horn

© 2025 KIMLEY-HORN AND ASSOCIATES, INC.
2 NORTH 20TH STREET, SUITE 800, BIRMINGHAM, AL 35203
PHONE: 205-558-6645

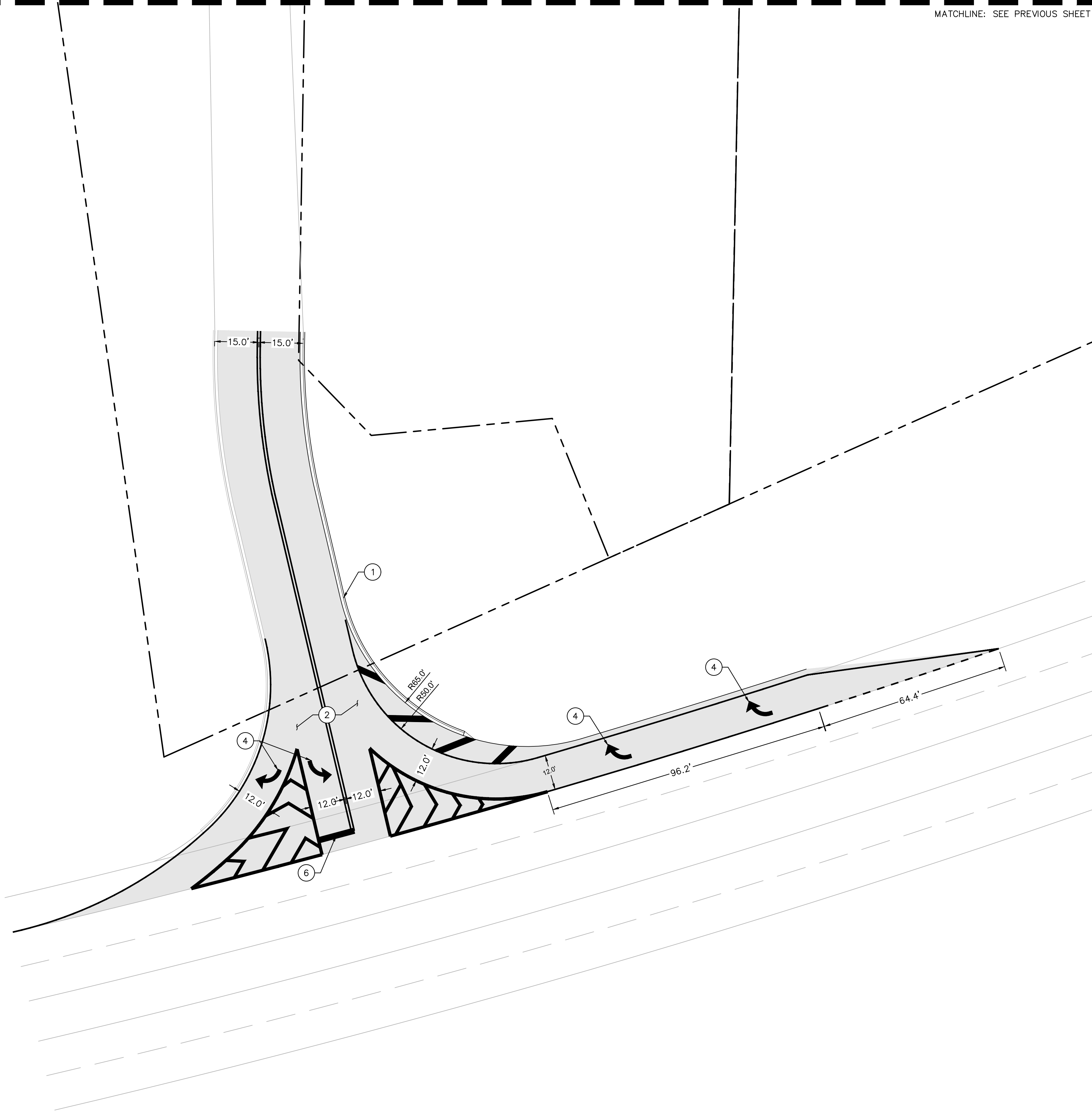

WALMART FUEL STATION - STORE #1961
6711 EAST ALEXANDRIA PIKE, ALEXANDRIA, KY 41001
DESIGN CIVIL SITE PLAN

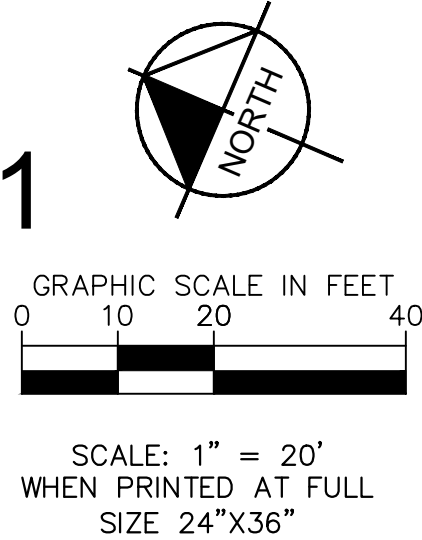

LEGEND	
	PROPERTY LINE
	EXISTING EASEMENT LINE
	HEAVY DUTY ASPHALT PAVING
	LANDSCAPING
	CONCRETE SIDEWALK
	CONCRETE PAVEMENT
	TRUNCATED DOMES

- CONSTRUCTION NOTES
- 1 PROPOSED CONCRETE CURB AND GUTTER.
 - 2 PROPOSED HEAVY DUTY ASPHALT PAVEMENT.
 - 3 PROPOSED CONCRETE PAVEMENT.
 - 4 STRIPE DIRECTIONAL ARROW PAVEMENT MARKING.
 - 5 PROPOSED 4" YELLOW STRIPING ANGLED 45°.
 - 6 STRIPE STOP BAR PAVEMENT MARKING.
 - 7 PROPOSED STOP SIGN ON POST.
 - 8 PROPOSED LANDSCAPING (SEE LANDSCAPE PLAN).
 - 9 PROPOSED 1,618 SF CONVENIENCE STORE.
 - 10 PROPOSED UNDERGROUND GAS TANKS. ONE 20,000 GAL UNL, ONE 20,000 GAL SPLIT (12,000 UNL/8,000 PRM), AND ONE 20,000 GAL DSL.
 - 11 PROPOSED AIR STATION.
 - 12 PROPOSED VAPOR RECOVERY LOCATION/PAD.
 - 13 PROPOSED CANOPY.
 - 14 PROPOSED TRUNCATED DOMES.
 - 15 PROPOSED VAN ACCESSIBLE PARKING SIGN ON POST AND BOLLARD.
 - 16 PROPOSED VAN ACCESSIBLE PARKING.
 - 17 PROPOSED BOLLARD.
 - 18 PROPOSED CONCRETE SIDEWALK.
 - 19 PROPOSED TRASH ENCLOSURE.
 - 20 PROPOSED REGULAR PARKING.
 - 21 PROPOSED TRANSFORMER PAD SHOWN FOR REFERENCE ONLY.
 - 22 PROPOSED SITE LIGHTING (SEE PHOTOMETRIC PLAN).
 - 23 PROPOSED VALLEY GUTTER.
 - 24 PROPOSED BIKE RACK.

SITE ANALYSIS TABLE		
FUEL STATION ADDRESS	6711 EAST ALEXANDRIA PIKE, ALEXANDRIA, KY 41001	
CURRENT ZONING	NSC	
EXISTING PARCEL AREA	28.28 ACRES	
EXISTING WALMART BUILDING AREA	211,091 S.F.	
PROPOSED FUEL AREA	1.24 ACRES	
PROPOSED FUEL BUILDING AREA	1,440 S.F.	
	PARKING COUNT	PARKING RATIO
EXISTING TOTAL PARKING	941 SPACES	4.46/1,000 S.F.
EXISTING STANDARD STALLS	911 SPACES	---
EXISTING ADA STALLS	30 SPACES	---
PROPOSED TOTAL PARKING	775 SPACES	3.67/1,000 S.F.
CITY REQ. PARKING	950 SPACES	4.50/1,000 S.F.
WALMART REQ. PARKING	845 SPACES	4.00/1,000 S.F.
PROPOSED FUEL AREA PARKING		
PROPOSED STANDARD STALLS	15 SPACES	---
PROPOSED ADA STALLS	1 SPACES	---
TOTAL PROPOSED STALLS	16 SPACES	---

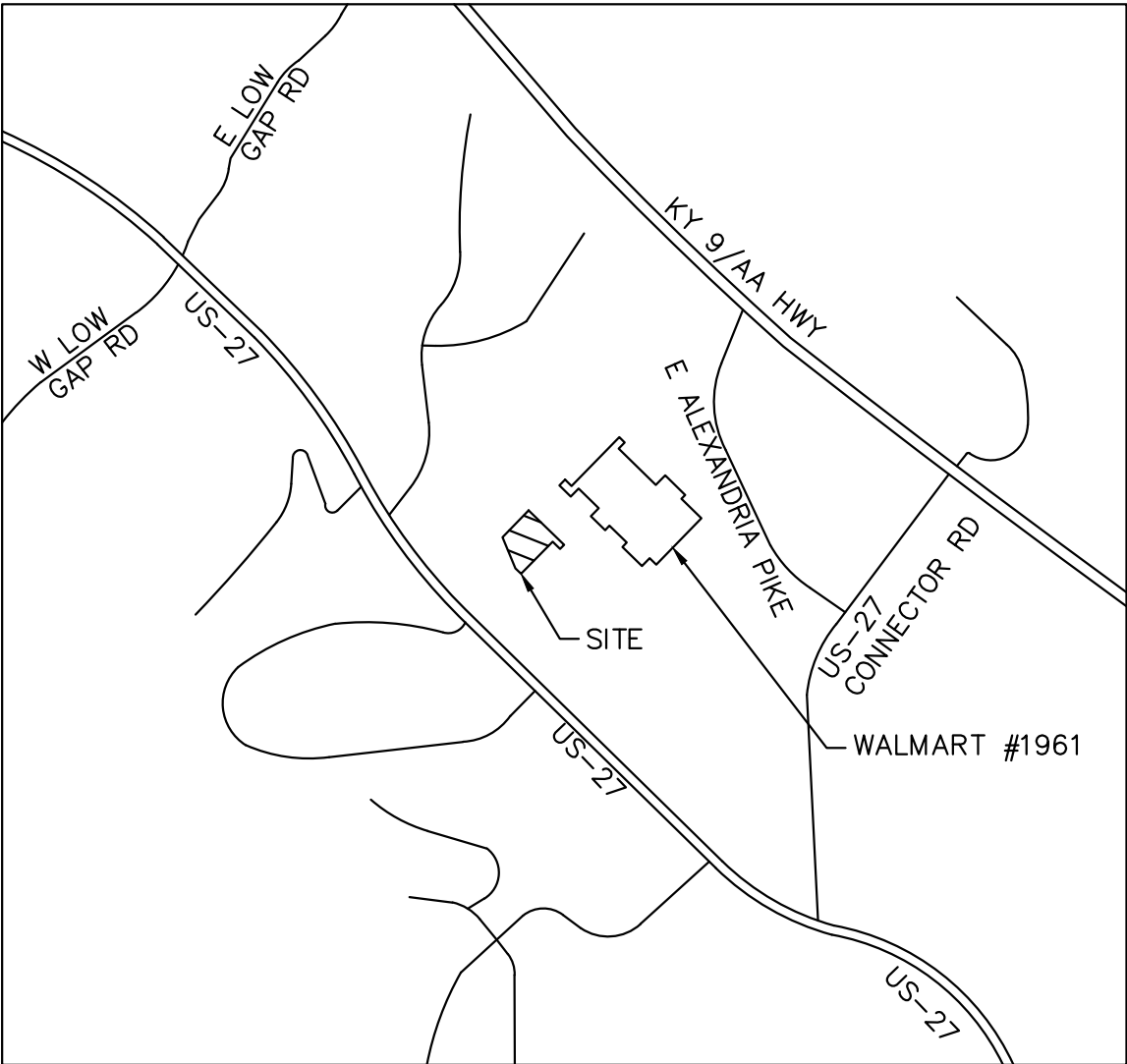

VICINITY MAP
N.T.S.

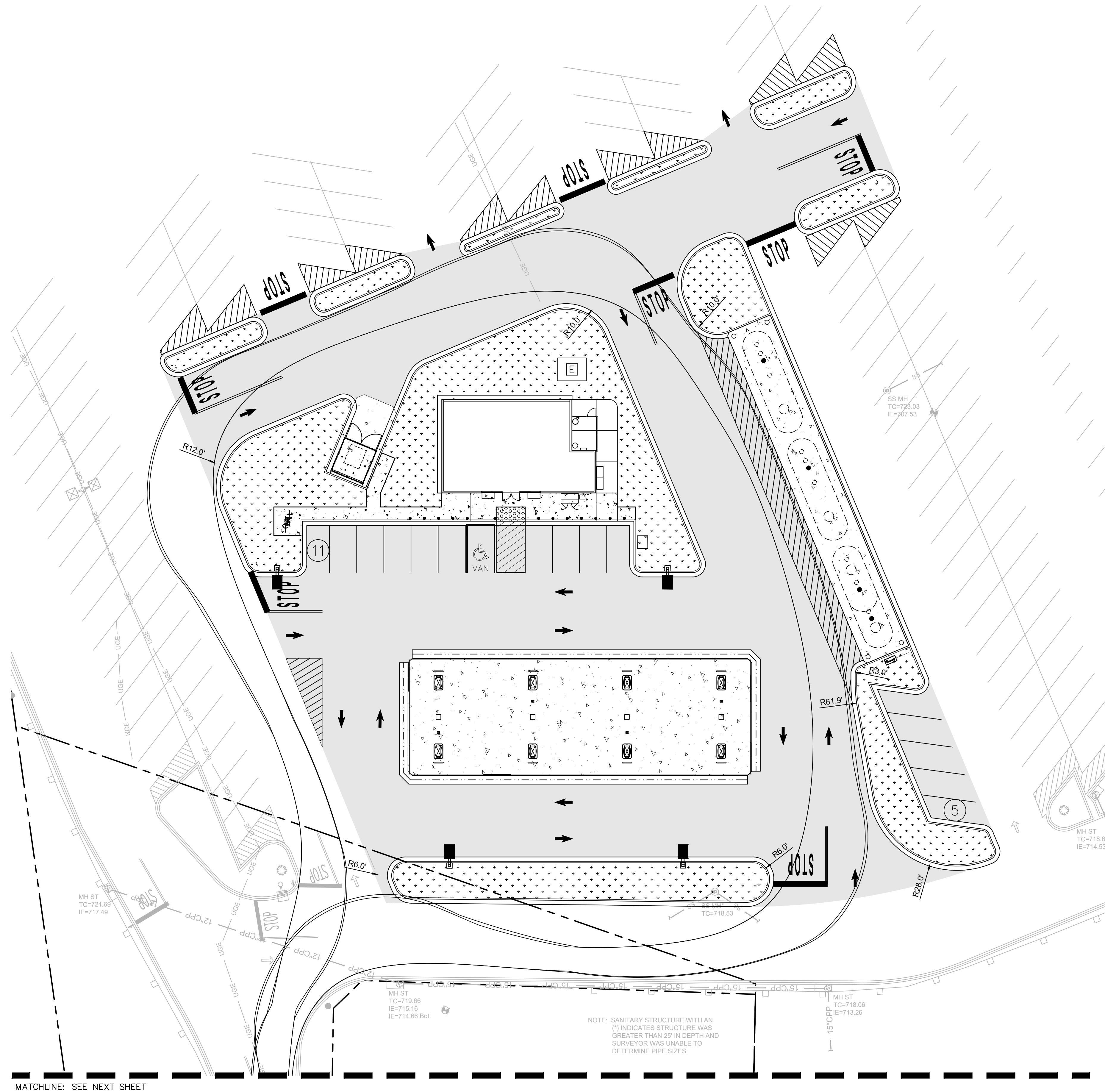

MATCHLINE: SEE NEXT SHEET

WALMART FUEL STATION - STORE #1961

6711 EAST ALEXANDRIA PIKE, ALEXANDRIA, KY 41001

DESIGN CIVIL TRUCK TURN

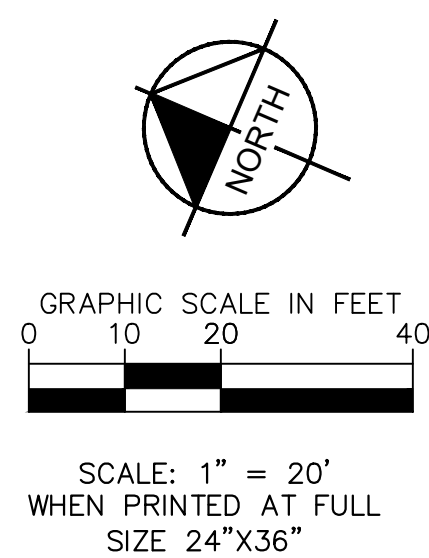

LEGEND

	PROPERTY LINE
	EXISTING EASEMENT LINE
	HEAVY DUTY ASPHALT PAVING
	LANDSCAPING
	CONCRETE SIDEWALK
	CONCRETE PAVEMENT

TRUCK DIAGRAM

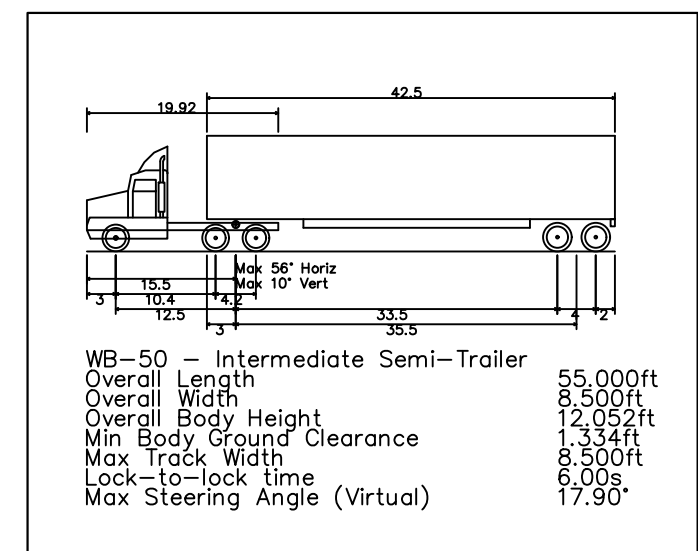

OVERALL PLAN

SCALE 1" = 200'

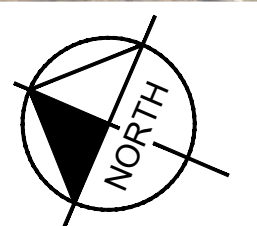

MATCHLINE: SEE PREVIOUS SHEET

LEGEND

	PROPERTY LINE
	EXISTING EASEMENT LINE
	HEAVY DUTY ASPHALT PAVING
	LANDSCAPING
	CONCRETE SIDEWALK
	CONCRETE PAVEMENT

TRUCK DIAGRAM

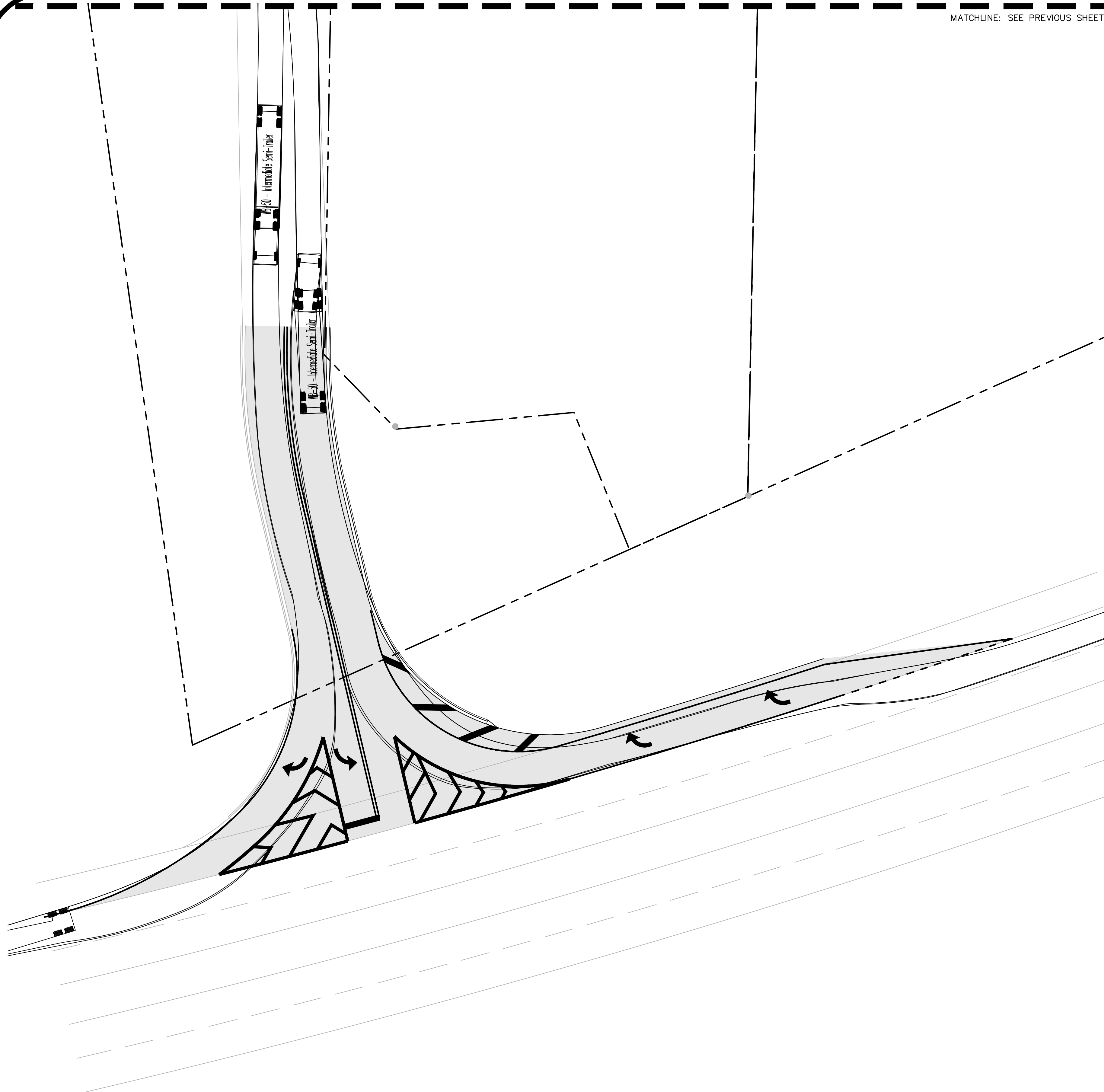
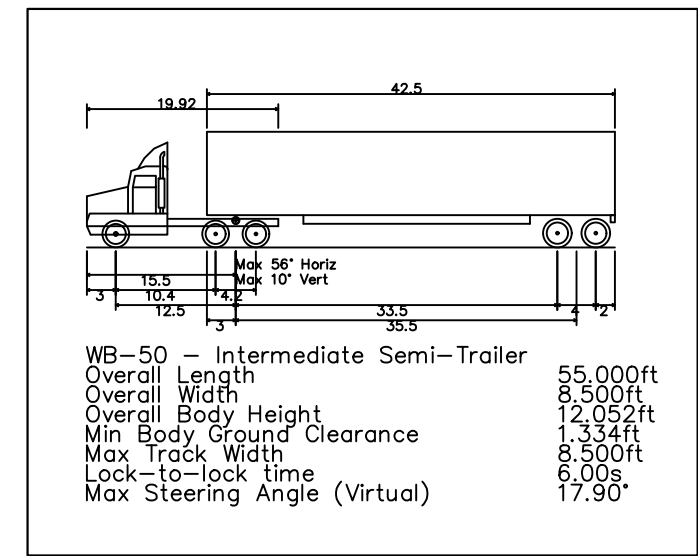

WALMART FUEL STATION - STORE #1961 6711 EAST ALEXANDRIA PIKE, ALEXANDRIA, KY 41001 DESIGN CIVIL TRUCK TURN

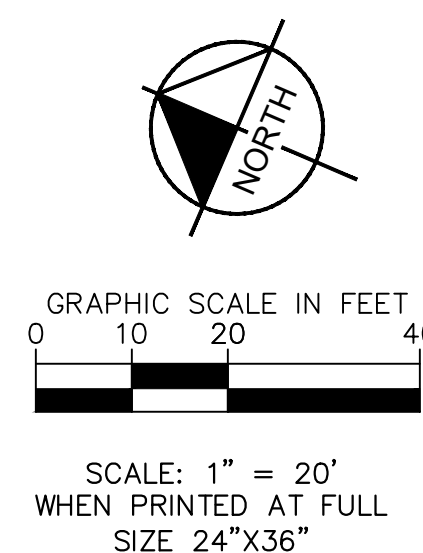

OVERALL PLAN SCALE 1" = 200'

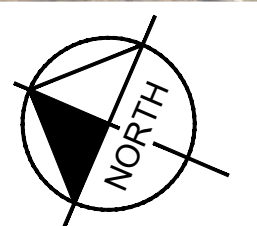

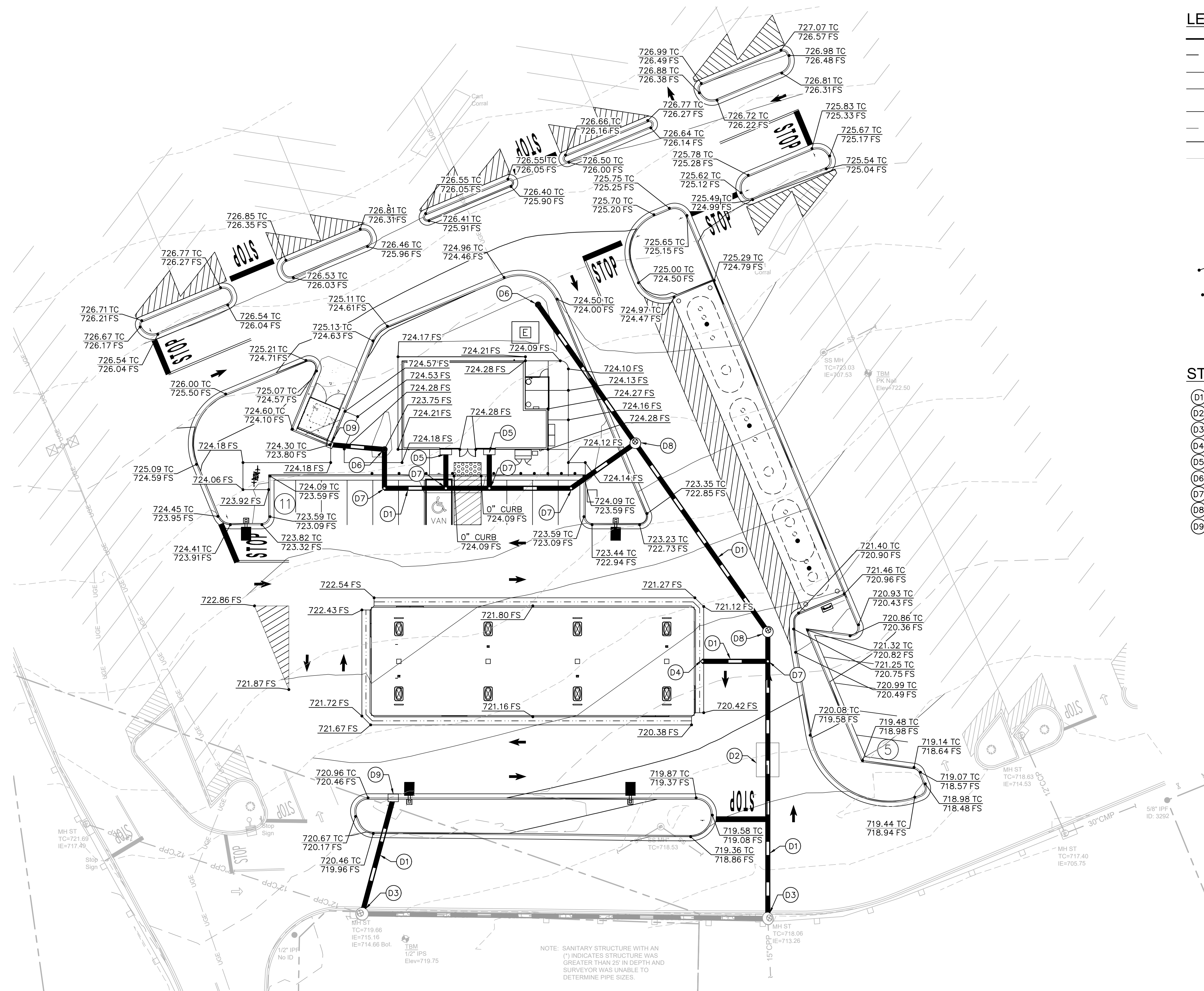

LEGEND

---	PROPERTY LINE
---	EXISTING EASEMENT LINE
GB	PROPOSED GRADE BREAK
R	PROPOSED RIDGE LINE
1421	PROPOSED CONTOUR
-1421	EXISTING CONTOUR
SD	PROPOSED STORM DRAIN LINE
SD	EXISTING STORM DRAIN LINE
FF	FINISH FLOOR ELEVATION
FL	FLOWLINE
LIP	LIP OF GUTTER
TC	TOP OF CURB
FS	FINISH SURFACE
(1421.50 TC) (1421.00 FS)	EXISTING GRADE
1421.50 TC 1421.00 FS	PROPOSED GRADE
X.X%	PROPOSED SLOPE

STORM DRAIN

- (D1) PROPOSED STORM DRAIN PIPE.
- (D2) PROPOSED OIL WATER SEPARATOR.
- (D3) POINT OF CONNECTION FOR STORM DRAIN.
- (D4) PROPOSED CONNECTION FOR CANOPY ROOF DRAINAGE.
- (D5) PROPOSED ROOF DRAIN CONNECTION.
- (D6) PROPOSED BEEHIVE YARD INLET.
- (D7) PROPOSED STORM CLEANOUT
- (D8) PROPOSED JUNCTION BOX.
- (D9) PROPOSED INLET.

WALMART FUEL STATION - STORE #1961 6711 EAST ALEXANDRIA PIKE, ALEXANDRIA, KY 41001 DESIGN CIVIL GRADING PLAN

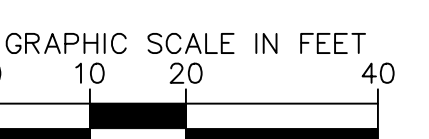
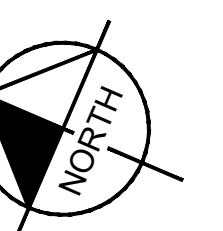

SCALE: 1" = 20'
WHEN PRINTED AT FULL
SIZE 24"X36"

Kimley»Horn

© 2025 KIMLEY-HORN AND ASSOCIATES, INC.
2 NORTH 20TH STREET, SUITE 800, BIRMINGHAM, AL 35203
PHONE: 205-558-6645

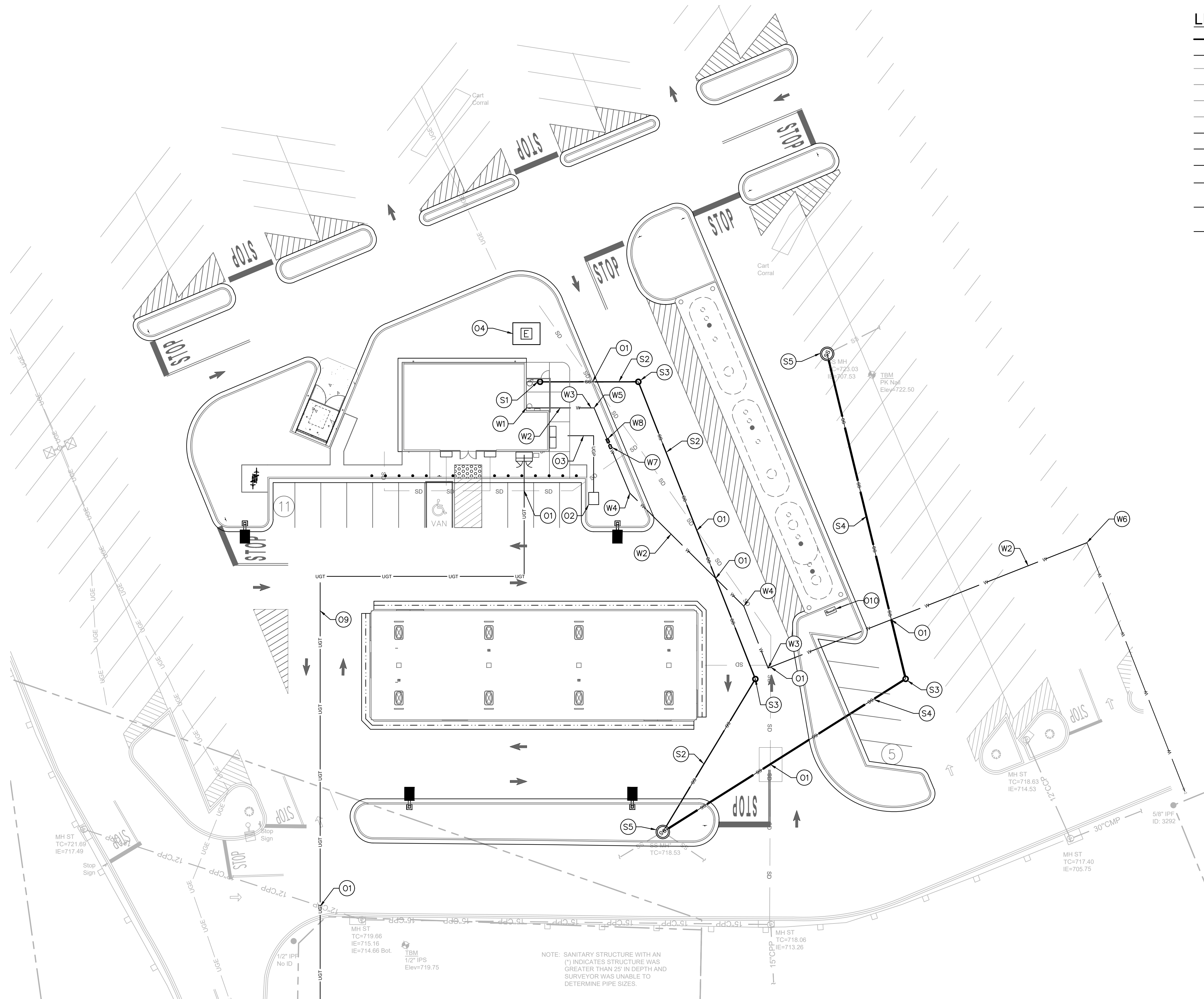

LEGEND

---	PROPERTY LINE
---	EXISTING EASEMENT LINE
---	EXISTING STORM DRAIN LINE
---	EXISTING WATER LINE
---	EXISTING SANITARY LINE
---	EXISTING ELECTRIC LINE
---	PROPOSED WATER LINE
---	PROPOSED SANITARY LINE
---	PROPOSED ELECTRIC LINE
---	PROPOSED STORM DRAIN LINE
---	PROPOSED UNDERGROUND POWER LINE
---	PROPOSED UNDERGROUND FIBER OPTIC LINE

SEWER

- (S1) BUILDING POINT OF CONNECTION (5-FT FROM BUILDING FACE). REFER TO MEP PLANS FOR CONTINUATION.
- (S2) INSTALL 4" SDR-PVC SEWER LATERAL
- (S3) INSTALL SANITARY SEWER CLEANOUT
- (S4) INSTALL 8" SDR-PVC SEWER LATERAL
- (S5) CONNECT TO EXISTING SANITARY MANHOLE

DOMESTIC WATER

- (W1) 1.5" BUILDING POINT OF CONNECTION (5-FT FROM BUILDING FACE). REFER TO PLUMBING PLANS FOR CONTINUATION.
- (W2) INSTALL 1.5" SCHEDULE 40 DOMESTIC WATER PIPE.
- (W3) INSTALL 1.5" SCHEDULE 40 90° BEND.
- (W4) INSTALL 1.5" SCHEDULE 40 22.5° BEND.
- (W5) INSTALL 1.5" SCHEDULE 40 67.5° BEND.
- (W6) POINT OF CONNECTION TO EXISTING WATER LATERAL STUB.
- (W7) PROPOSED 1.5" WATER METER. COORDINATE INSTALL WITH LOCAL PURVEYOR.
- (W8) PROPOSED 1.5" BACKFLOW PREVENTER. GENERAL CONTRACTOR SHALL RECEIVE BACKFLOW APPROVAL FROM WATER PURVEYOR PRIOR TO ORDERING BACKFLOW.

OTHER UTILITY NOTES

- (O1) PROPOSED UTILITY CROSSING.
- (O2) PROPOSED AIR PEDESTAL.
- (O3) 1" CONDUIT TO AIR PEDESTAL.
- (O4) PROPOSED TRANSFORMER.
- (O5) PROPOSED CONDUIT FOR 400 AMP ELECTRIC SERVICE. REFER TO UTILITY COMPANY PLAN/REQUIREMENTS FOR MORE INFORMATION.
- (O6) PROPOSED POWER POINT OF CONNECTION TO BUILDING (SEE MEP PLANS FOR CONTINUATION)
- (O7) POINT OF CONNECTION TO EXISTING TRANSFORMER.
- (O8) PROPOSED FIBER OPTIC POINT OF CONNECTION TO BUILDING (SEE MEP PLANS FOR CONTINUATION)
- (O9) PROPOSED FIBER OPTIC CONDUIT 3" DIRECTIONAL BORE OR APPROVED EQUAL WITH PULL BOXES EVERY 300' TO EXISTING WALMART SUPERCENTER KIOSK.
- (O10) VAPOR RECOVERY UTILITY.

WALMART FUEL STATION - STORE #1961
6711 EAST ALEXANDRIA PIKE, ALEXANDRIA, KY 41001
DESIGN CIVIL UTILITY PLAN

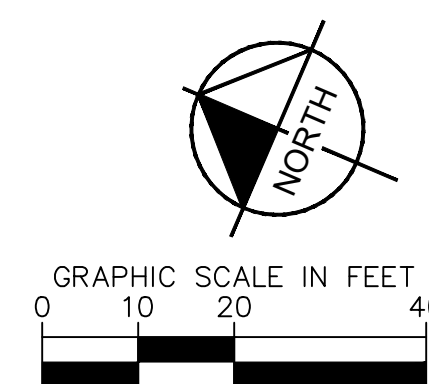

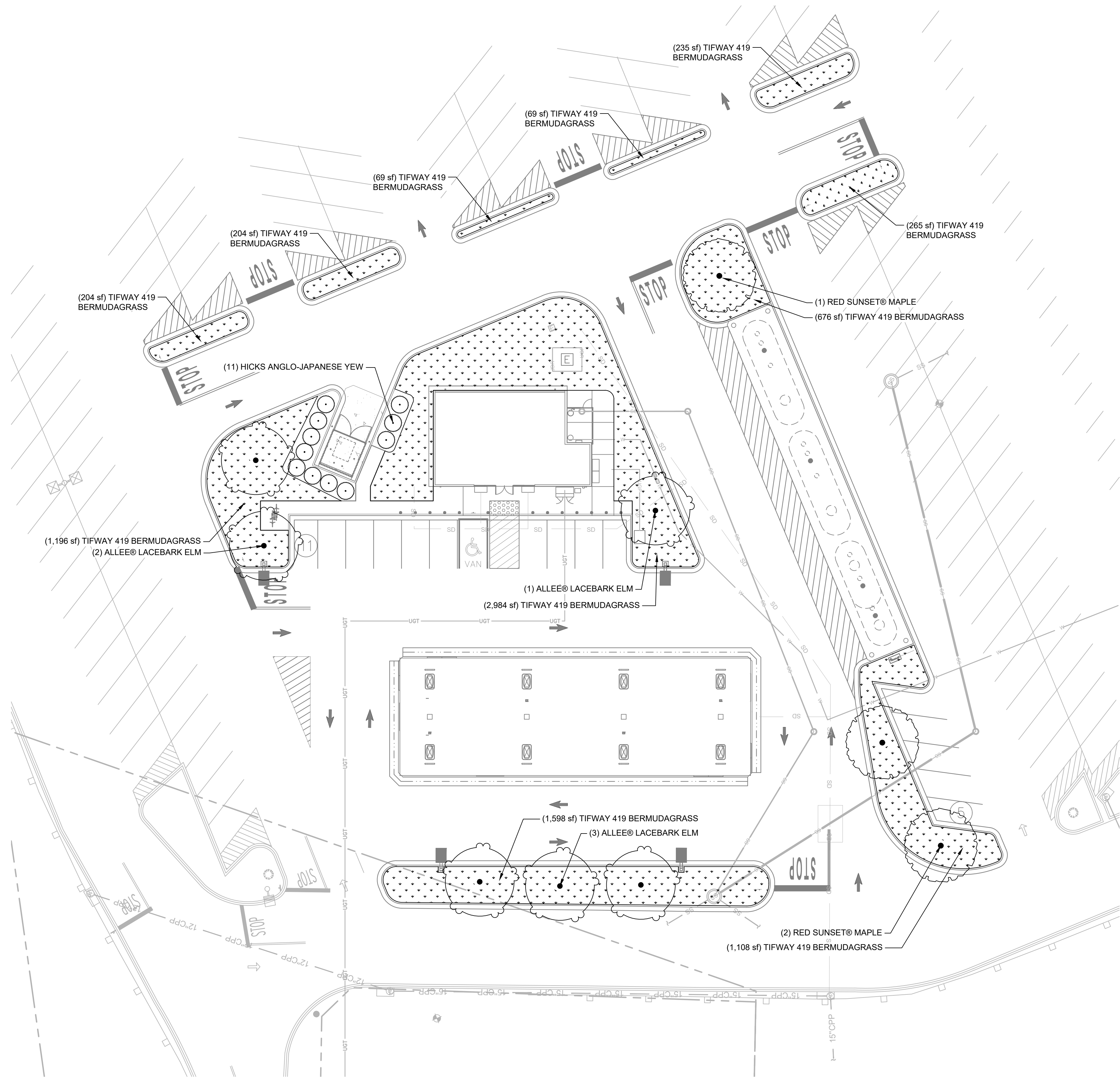

WALMART FUEL STATION - STORE #1961
6711 EAST ALEXANDRIA PIKE, ALEXANDRIA, KY 41001
DESIGN CIVIL LANDSCAPE PLAN

LEGEND

---	PROPERTY LINE
- - -	EXISTING EASEMENT LINE
[Solid Grey Box]	HEAVY DUTY ASPHALT PAVING
[Grid Pattern Box]	CONCRETE SIDEWALK
[Dotted Pattern Box]	CONCRETE PAVEMENT
[Circular Pattern Box]	TRUNCATED DOMES

PLANT SCHEDULE

SYMBOL	QTY	BOTANICAL / COMMON NAME	SIZE	ROOT	CONDITION
TREES					
[Tree Symbol]	3	Acer rubrum 'Frankred' / Red Sunset® Maple	2" Caliper, 5' min. Clear Trunk Ht.	B&B	Matching, Strong Central Leader
[Tree Symbol]	6	Ulmus parvifolia 'Allee' / Allee® Lacebark Elm	2" Caliper, 5' min. Clear Trunk Ht.	B&B	Matching, Strong Central Leader
SHRUBS					
[Shrub Symbol]	11	Taxus x media 'Hicksii' / Hicks Anglo-Japanese Yew	3 Gallon, 24" Min. Ht.	Container	Matching; Full to Ground
GROUND COVERS					
[Ground Cover Symbol]	8,607 sf	Cynodon dactylon 'Tifway 419' / Tifway 419 Bermudagrass	Sod	Sod, Pin Slopes Greater Than 3:1	Sod; Free of Weeds

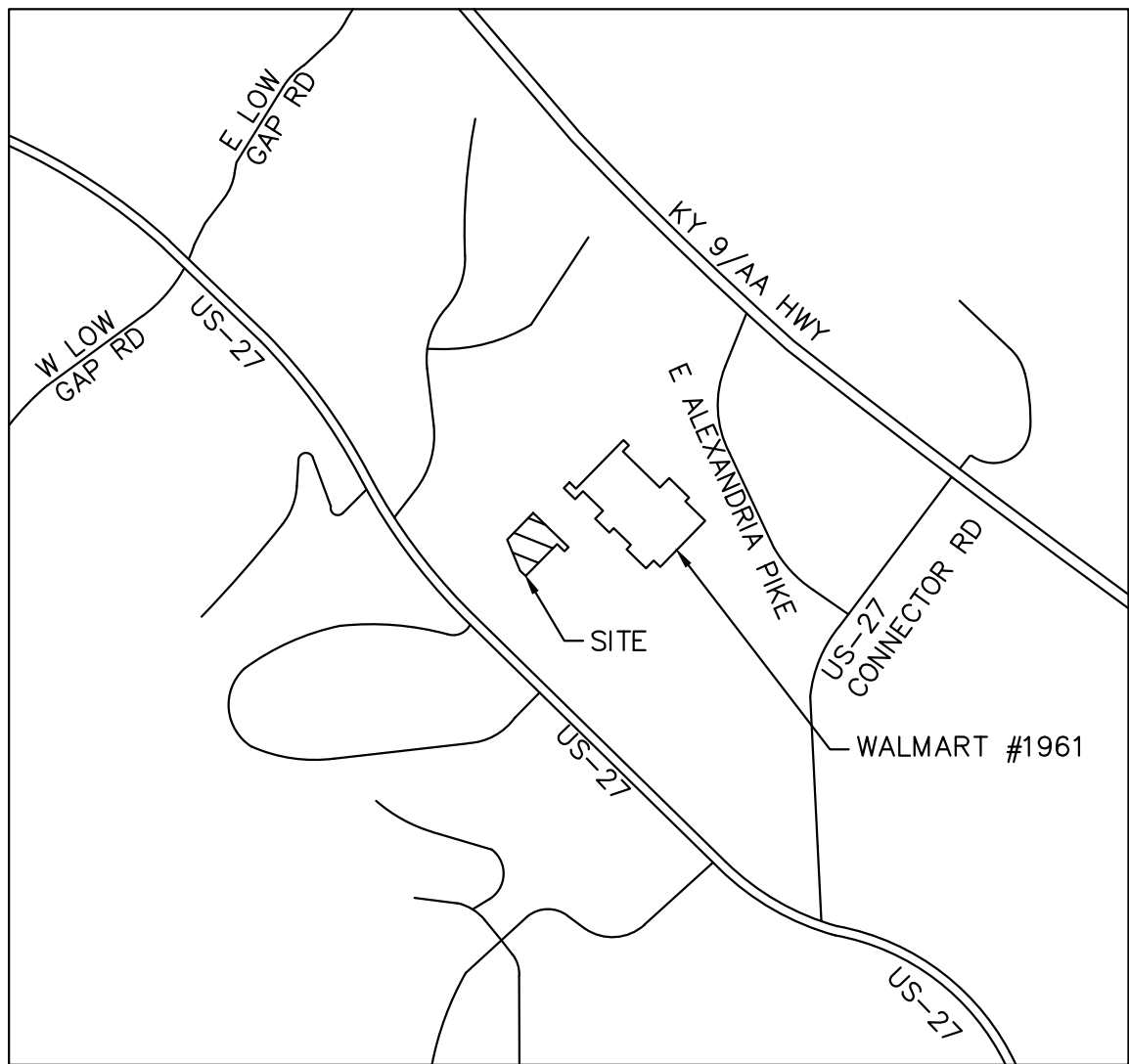

VICINITY MAP
N.T.S.

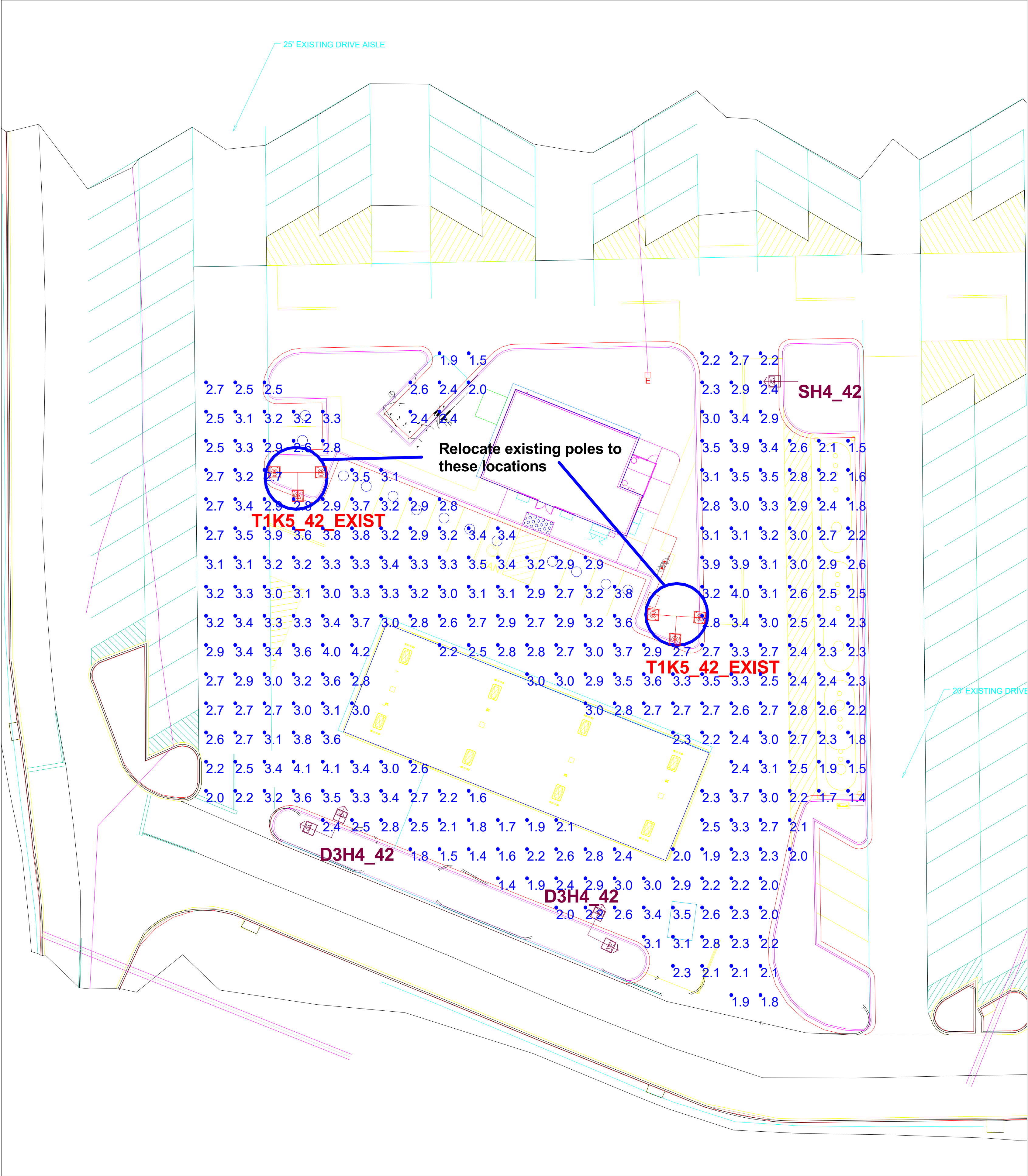

Scale: 1 inch= 20 Ft.
THIS IS A D SIZE SHEET. THE NOTED SCALE IS NOT VALID IF PRINTED AS ANY OTHER SIZE.

Calculation Summary							
Label	CalcType	Units	Avg	Max	Min	Avg/Min	Max/Min
Fuel Zone	Illuminance	Fc	2.80	4.2	1.4	2.00	3.00

Luminaire Schedule								
Symbol	Qty	Label	Arrangement	LLF	Description	Arr. Watts	Arr. Lum. Lumens	BUG Rating
	2	D3H4_42	2 @ 90 DEGREES_1	0.837	2-EALS035H4AF750NDD1BLCKF 39ft pole on 3ft base	280	40000	B3-U0-G3
	1	SH4_42	SINGLE	0.837	1-EALS035H4AF750NDD1BLCKF 39ft pole on 3ft base	140	20000	B3-U0-G3
	2	T1K5_42_EXIST	3 @ 90 DEGREES	0.765	3-EASCSK5N550DBBLCKDF 39ft pole on 3ft base	849	90000	B5-U0-G3

LED STATISTICS SHOWN ARE AT 50000 HOURS L85 & L93 RATING (~12 YEARS @ 12 HRS/DAY)

L85 = OPERATING HOURS AT WHICH AN AVERAGE OF 15% OF INITIAL LUMENS HAVE BEEN LOST IN A TESTED POPULATION OF LED PLATFORMS. THE POPULATION STILL EMITS 85% OF INITIAL LUMENS. THE LUMINAIRE HAS NOT FAILED. IT IS STILL OPERATING WITH A REDUCED LIGHT OUTPUT.

L93 = OPERATING HOURS AT WHICH AN AVERAGE OF 7% OF INITIAL LUMENS HAVE BEEN LOST IN A TESTED POPULATION OF LED PLATFORMS. THE POPULATION STILL EMITS 93% OF INITIAL LUMENS. THE LUMINAIRE HAS NOT FAILED. IT IS STILL OPERATING WITH A REDUCED LIGHT OUTPUT.

IN COMPARISON, NON-LED LUMINAIRES ARE RATED WITH MEAN LUMENS MEASURED AT 40-50% OF RATED LIFE, DEPENDING ON TECHNOLOGY, AND RATED LIFE OF B50, WHERE B50 = OPERATING HOURS AT WHICH 50% OF A TESTED POPULATION OF LAMPS HAVE FAILED.

PROPERTY LINES BASED OFF PROVIDED LIGHTING RETROFIT SURVEY AND GOOGLE EARTH PRO. CALCULATION AREAS TREATED AS OPEN AND EMPTY. NO TREES ARE CONSIDERED IN THE DESIGN, ACTUAL VALUES MAY VARY FROM CALCULATED VALUES SHOWN.

The magnitude of the differences between detailed analysis methods and field measurements varies. In general, differences of less than 20% can be expected, but in extreme cases, where a calculation method cannot handle the complexity of the lighting system, they may be greater. A more complete discussion of the considerations is available.

AH81/ESLS-4-20
Lighting Science: Calculation of Light and its Effects

Provided for:

CURRENT

Provided BY:

Application Solution Center
apps@currentlighting.com

6085 Parkland Blvd,
Mayfield Heights, OH 44124

Designer: Joshua Watkins

Date: 5/16/2025

Drawing #: A250983-Walmart #1961 Alexandria, KY Fuel Station-AGI

Walmart #1961 Alexandria, KY Fuel Station
A250983A

GE EVOLVE LED AREA LIGHT (EALS) 5000K CCT
MOUNTING HEIGHT - 42 FT POLES, 16 FT WALL MTD.
TARGET HIGH CRIME SPEC
10'X10' CALCULATION GRID SPACING
HORIZONTAL POINTS AT GRADE, VERTICAL POINTS AT 5' AFG.
50,000 HOURS SHOWN

Page 1 of 1